

# AWA STREET WASTEWATER PUMP STATION FORCE MAIN AND SEWER SYSTEM IMPROVEMENTS WAIKAMILO ROAD TRUNK SEWER

NIMITZ HWY TO N. SCHOOL ST, HONOLULU, OAHU, HI

ADEQUATE SEWER SYSTEMS AND WASTEWATER MANAGEMENT PLAYS A VITAL ROLE IN SANITATION AND PREVENTION OF DISEASE FOR THE PEOPLE AND COMMUNITIES OF HAWAII.

The City and County of Honolulu (City) was mandated by the United States Government through the 2010 Global Consent Decree (GCD) to eliminate all sanitary sewer overflows.

This project originally intended to address a consent decree project to upgrade the Awa Street Wastewater Pump Station (WWPS) by expanding its capacity. It was identified that redirecting wastewater flow by constructing a new trunk sewer along Waikamilo Road, from North School Street to Nimitz Highway, would address three separate consent decree projects. This diversion of wastewater lightened the load on the Awa Street WWPS and eliminated the need to improve approximately 55,820 linear feet of sewer lines. The project team's resourcefulness and problem-solving during planning found a single solution to address three separate consent decree projects.

To accomplish this diversion, the existing wastewater flow direction needed to be reversed along Dillingham Boulevard, Colburn Street, and the makai ends of Kohou Street and Waikamilo Road. In addition to the challenge of reversing sewer flows, the project involved constructing approximately 10,500 linear feet of new 8-inch to 54-inch diameter gravity sewer lines along Waikamilo Road and Houghtaling Street, and along several of the connecting side streets. Construction was completed by excavating 20-ft wide (sq) and 20-ft deep shafts to install the trunk sewer using micro-tunneling technology.



Shaft Construction



Shaft Construction



42-Inch Waterline Relocation



Receiving Shaft

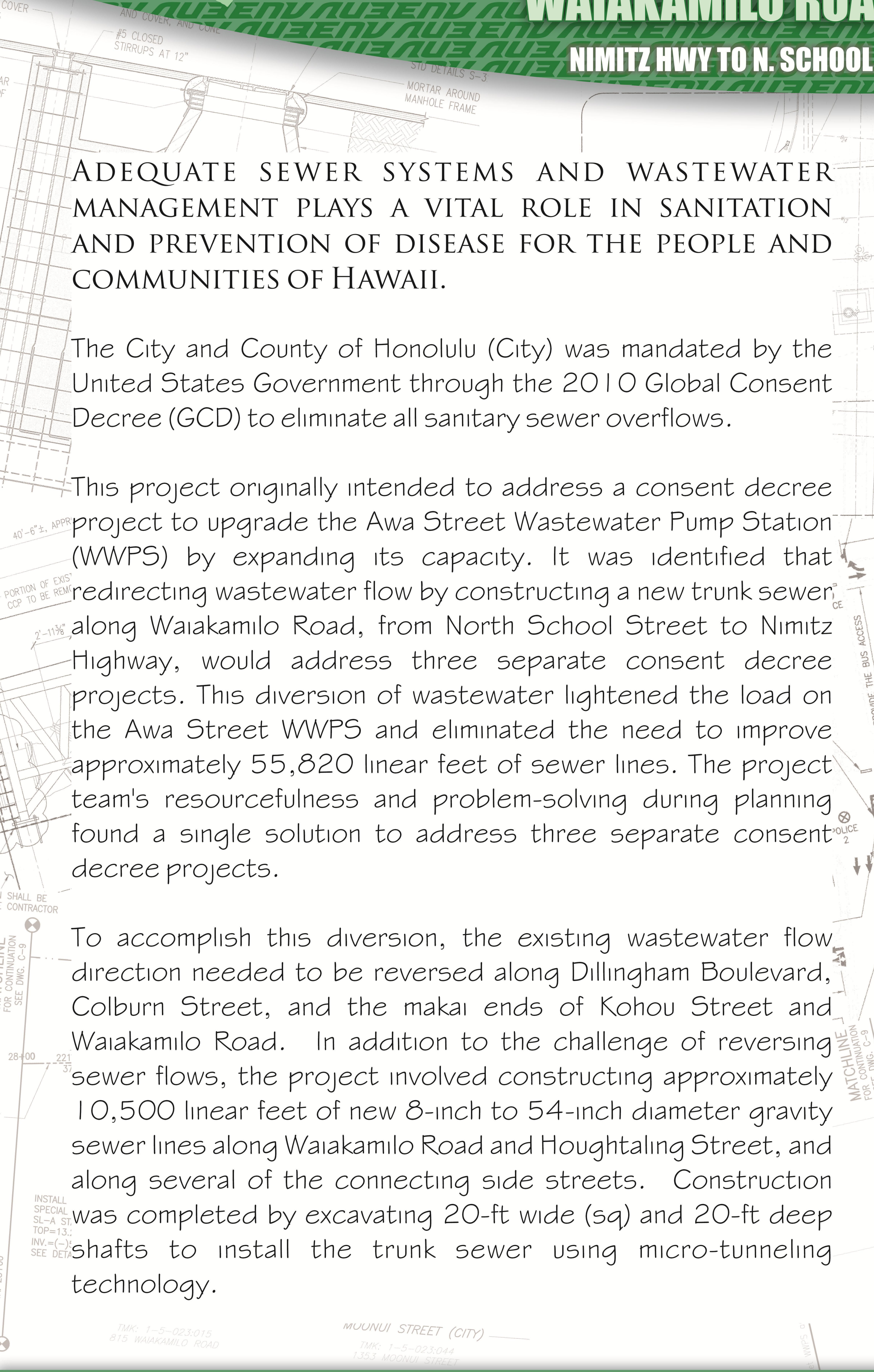
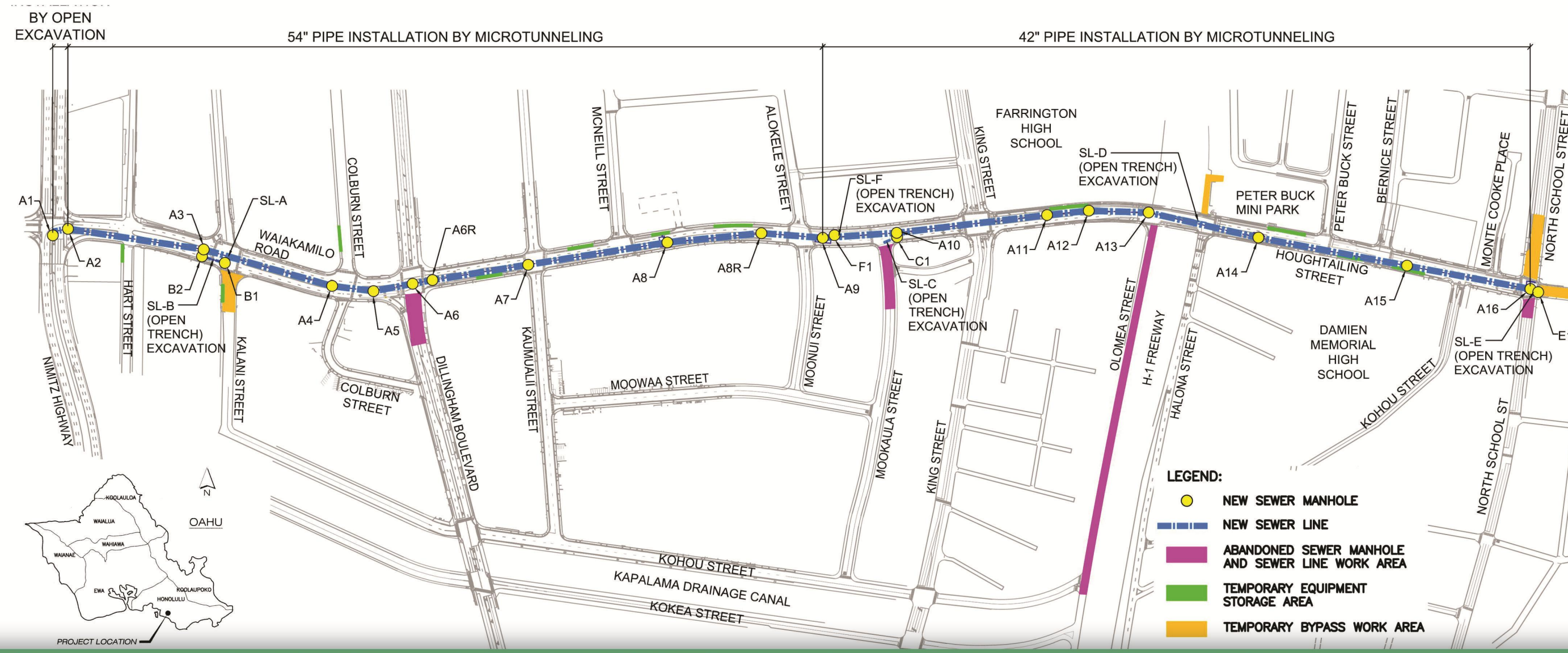

**DESIGN TEAM**  
OKAHARA AND ASSOCIATES, INC  
PRIME CONSULTANT / CIVIL CONSULTANTS  
YOGI KWONG ENGINEERS LLC  
GEOTECHNICAL CONSULTANTS  
RONALD N.S. HO & ASSOCIATES  
ELECTRICAL CONSULTANTS  
KAI HAWAII INC  
STRUCTURAL CONSULTANTS  
CONTROLPOINT SURVEYING INC  
SURVEYORS

ENVIRONMENTAL SCIENCE INTERNATIONAL  
ENVIRONMENTAL CONSULTANTS  
THE TRAFFIC MANAGEMENT CONSULTANT  
TRAFFIC CONSULTANTS  
Y. EBISU & ASSOCIATES INC  
ACOUSTICAL CONSULTANTS  
TOWNSCAPE INC  
PLANNERS  
CULTURAL SURVEYS HAWAII INC  
ARCHAEOLOGICAL

**GENERAL CONTRACTOR**  
FV COLUCCIO CONSTRUCTION CO INC  
**CONSTRUCTION MANAGER**  
YOGI KWONG ENGINEERS LLC

